

## Aluminum Medium Capacity Single-Point Load Cell



### FEATURES

- Capacities 50–250 kg
- Aluminum construction
- Single-point 400 x 400 mm platform
- OIML R60 and NTEP approved
- IP66 protection
- Available with metric and UNC threads

### OPTIONAL FEATURE

- EEx ia IIC T4 - hazardous area approval
- FM approval available

### DESCRIPTION

Model 1242 is a high accuracy, low profile, low cost, two-beam, single-point load cell ideally suited for industrial application where space is limited. Typical applications include platforms, hanging scales and personal weighers.

This high accuracy load cell is OIML R60 class C6 approved. For hazardous environments this load cell has EEx ia IIC T4 level of approval, as well as Factory Mutual approval.

A special humidity resistant protective coating assures long-term stability over the entire compensated temperature range.

The two additional sense wires feed back the voltage reaching the load cell. Complete compensation of changes in lead resistance due to temperature change and/or cable extension can be achieved by feeding this voltage into the appropriate electronics.

### APPLICATIONS

- Small platforms
- Hanging scales
- Personal scales

### OUTLINE DIMENSIONS in mm

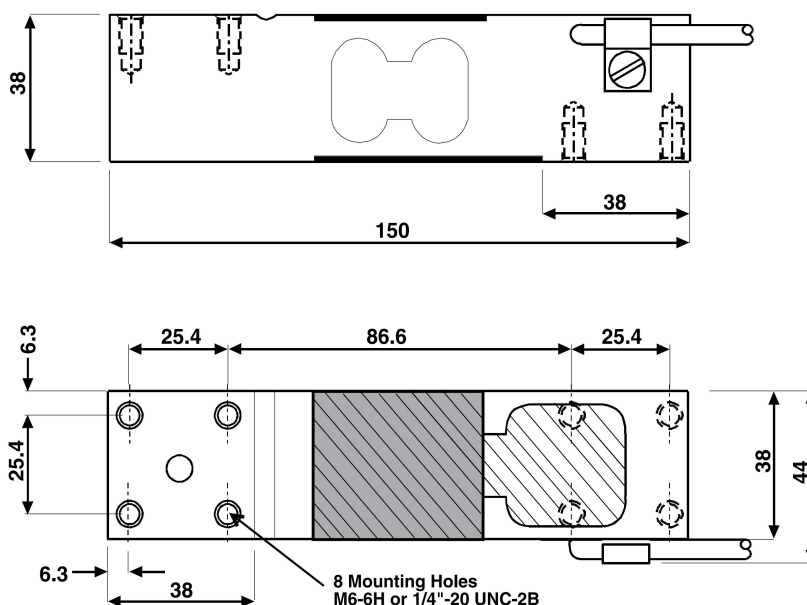

All dimensions in mm

**SPECIFICATIONS**

PARAMETER	VALUE			UNIT
Rated capacity—R.C. (Emax)	5, 7, 10, 15, 20, 30, 50, 75, 100			kg
NTEP/OIML accuracy class	NTEP	Non-Approved	C3*	
Maximum no. of intervals (n)	5000 single	1000	3000	
Y = Emax/Vmin	6000	1400	6000	Maximum available 10000
Rated output—R.O.	2.00			mV/V
Rated output tolerance	0.2			±mV/V
Zero balance	0.2			±mV/V
Zero return, 30 min.	0.0330	0.0300	0.0170	±% of applied load
Total error	0.0200	0.0500	0.0200	±% of rated output
Temperature effect on zero	0.0023	0.0100	0.0023	±% of rated output/°C
Temperature effect on output	0.0010	0.0030	0.0010	±% of rated output/°C
Eccentric loading error	0.0049	0.0074	0.0049	±% of rated load/cm
Temperature range, compensated	-10 to +40			°C
Temperature range, safe	-20 to +70			°C
Maximum safe central overload	150			% of R.C.
Ultimate central overload	300			% of R.C.
Excitation, recommended	10			VDC or VAC RMS
Excitation, maximum	15			VDC or VAC RMS
Input impedance	415±15			Ohms
Output impedance	350±3			Ohms
Insulation resistance	>2000			Mega-Ohms
Cable length	1040: 1.0 1041: 0.5			m
Cable type	6 wire, PVC, single floating screen			Standard
Construction	Plated (anodized) aluminum 1040 aluminum—1041			
Environmental protection	IP65**			
Recommended torque	Up to 30 kg: 7.0 50 kg and up: 10.0			N*m
Platform size (max)	400 x 400			m

\* 50% utilization

\*\* 60% utilization

All specifications subject to change without notice.

**Wiring Schematic Diagram**  
(Balanced temperature compensation)